

# Flywheel Power Technology Case Study

Presented by  
Don Esterle, StrataSpace

**INTEROP<sup>®</sup>**

BUSINESS. TECHNOLOGY.  
ONE WEEK. ONE PLACE.

# Welcome To StrataSpace

- StrataSpace, LLC is a one-of-a-kind facility designed to be the most secure and operationally efficient data center ever developed.
- The 570,000-square-foot facility is 60 feet underground and carved out of solid limestone, which provides an unparalleled level of security and HVAC efficiency that simply cannot be achieved in an above-ground structure.
- StrataSpace is located in Kentucky just northeast of Louisville, which has the most affordable electric rates of any state in America.
- The low utility rates in Kentucky and the HVAC efficiencies in StrataSpace result in significantly reduced operating costs.

# Aerial View of 35 Acre Campus



**INTEROP**

# View From Main Road



# StrataSpace Advantages

- **Secure from Natural and Unnatural Disasters**
  - 570,000 sq.ft. underground facility
  - Safe from all natural disasters
  - Blast-hardened facility secure against conventional weapons and “vehicle bombs”
  - Secure perimeter around 35-acre surface campus in a rural area 14 miles from downtown Louisville
  - All key infrastructure, including generators and fuel storage located underground
  - Single purpose facility dedicated to datacenter operations

# Telecommunications Center

Redundant Fiber  
provided by AT&T and  
Insight Communications



# Infrastructure to Support Telecom Center

- 450 KVA Liebert UPS
- 3 Liebert FS Flywheels
- 120 Tons Cooling
- 650 kVA Generator



# Advantages to Flywheel UPS

- No batteries eliminates gas emissions and ventilation issues
- Significantly reduced footprint increased leaseable space
- Near-zero scheduled maintenance preferable due to highly secure nature of StrataSpace

# Existing Infrastructure

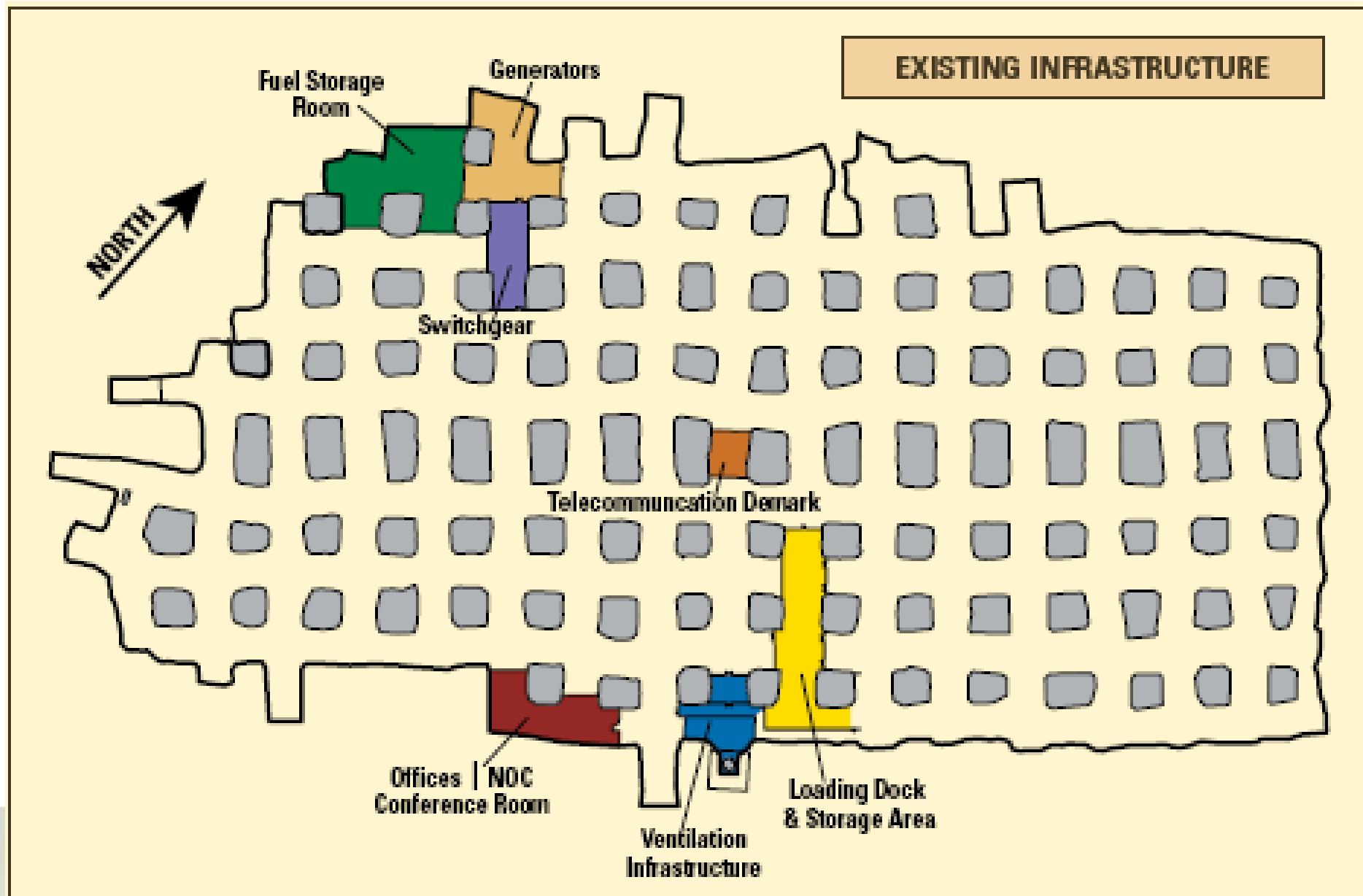

# Future Tenant Suites

RAISED FLOOR SUITES BUILT TO TENANT SPECIFICATIONS

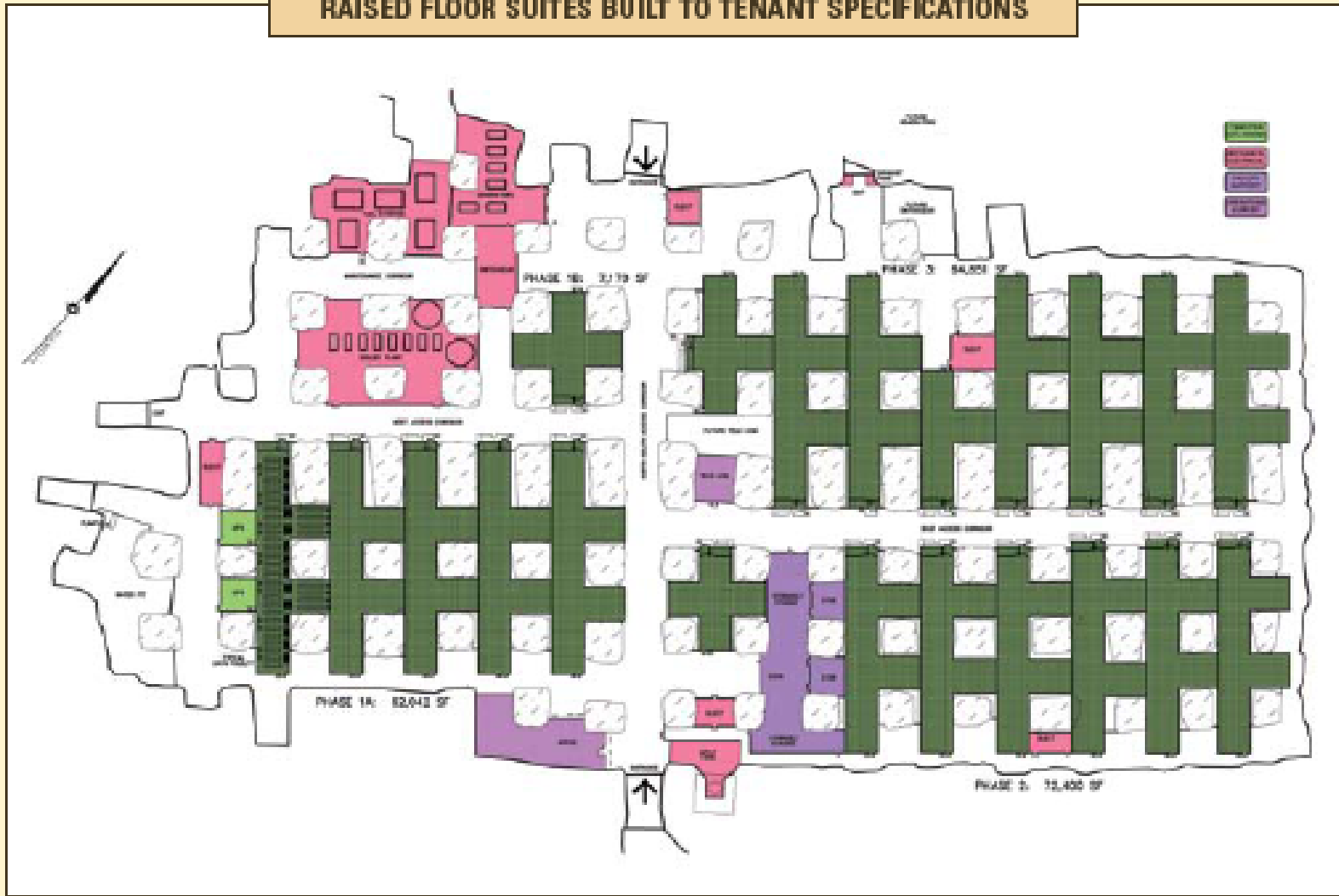

# Automated Ventilation System Capable of Exchanging Air 6 Times per Hour



**INTEROP**

# Rogers Group Investments

- Parent company founded 1908
- 1,800 employees
- Privately owned
- Annual revenues exceed \$600 million
- A diversified company



# Contact Information

- Larry Harms – President
  - Direct Phone: 502-326-2820
  - E-mail: [lharms@strataspace.com](mailto:lharms@strataspace.com)
- Don Esterle – Vice President Sales
  - Direct Phone: 502-326-2805
  - Cell: 502-594-6615
  - E-mail: [desterle@strataspace.com](mailto:desterle@strataspace.com)
- John Daugherty – Operations Manager
  - Direct Phone: 502-326-2803
  - E-mail: [jdaugherty@strataspace.com](mailto:jdaugherty@strataspace.com)