



WLAN Location Services

Ann Sun

Business Challenges Today

Cisco.com

- **Lack of visibility into the location of valuable assets and people**
- **Inefficient allocation and use of people and equipment**
- **Excessive cost of leasing & purchasing equipment to offset losses & theft**
- **Inefficient service resulting from long wait times & wasted search times**
- **Security issues linked to lack of insight into the location and movement of goods and people**



Location Services – The Killer App for WLAN?

Broad market application: enterprises, healthcare, finance, retail, manufacturing, distribution, government

- **Visibility & tracking of mobile devices**
- **Workflow automation & people tracking**
- **Telemetry**
- **WLAN security & network control**
- **RF capacity management & visibility**
- **E911**



Location Requires Great RF Technology

RF is dynamic - Environment is constantly changing

- **Accuracy despite user & device mobility**
- **Accounting for physical environment**
- **Compensating for/managing interference**
- **Time factor/trending – peaks/valleys of use**
- **Scalability - # of devices or clients**
- **Simple management**
- **Importance of leveraging WLAN infrastructure**

Maps > SJC14 > 3rd Floor

Contributing APs

- Conf Room A
- ap:1a:f2:d0
- NorthEast
- Conf Room B

Refresh Heatmap

```

Loading periodic refresh...
Loading AP information..
Done.
Loading heatmaps..
Done.
Loading RogueClients..
Loaded 2 out of 2 RogueClients
Done.
    
```

Rogues	0	94
Coverage	0	0
Security	0	0
Controllers	0	0
Access Points	0	1
Location Servers	0	

View **View Filters** **RSSI Color Lookup** **Zoom** **Refresh**
 -- Select an option -- -35 dBm -85 dBm **75 %** **5 min**

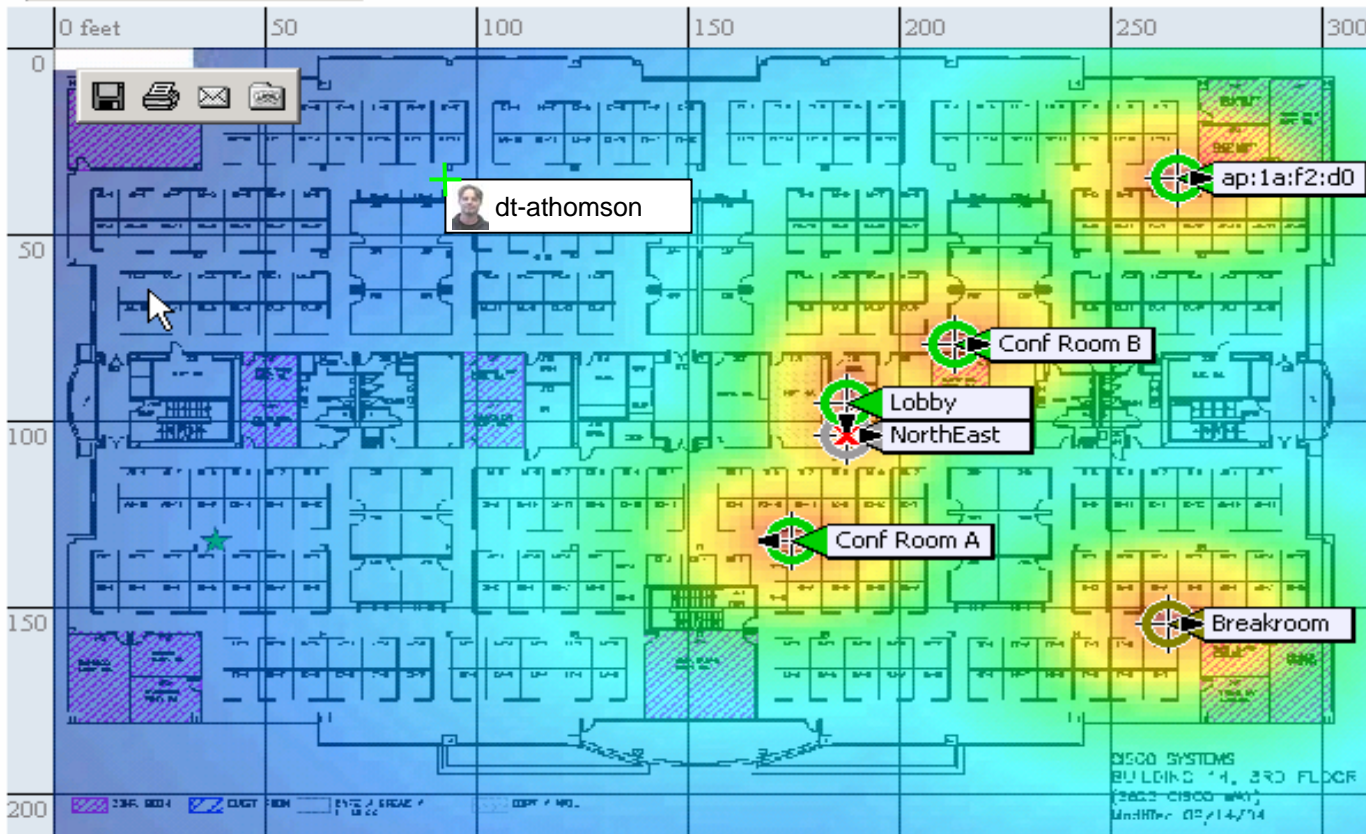

Summary

- **Growing base of embedded Wi-Fi devices**
- **Business operations enhanced through location services**
- **Dynamic RF environment and asset/user mobility**
- **Integrated location services leverages WLAN infrastructure**

CISCO SYSTEMS

